

400A Pole Mounted Fuse Switch Disconnecter

Pole Mounted Fuses with Disconnecter For L.V. System is specially designed as an on-load protective switch and offers a reliable medium for disconnection & protection of fully insulated open wire network section.

The unique modular design offers flexibility to connect switches for single, double, triple & quadruple phases. Series of such combinations can be linked together.

Construction

The switch is versatile and ideally suited for top mounting directly to poles, transformers and cross arms.

The fuseswitch disconnecter is fully insulated made from corrosion proof, impact resistant, weather & UV resilient glass fiber reinforced polyamide compound with high glass content.

This high quality of material, together with robust construction guarantees consistent performance even under adverse climatic conditions.

The upper housing of the switch is hinged to the lower body and houses the conductors, terminals and contacts. The operation of the switch is simple and safe with the help of insulated operating rod.

The fuse contacts are fully shrouded and terminals are made of ETP grade high conductivity copper duly tin plated which ensures minimum contact resistance besides offering flexibility to use copper or aluminum cables.

The switch and take conductor size of 50 to 240 sq.mm.

Features

- * Electrical & Mechanical fuse indicators.
- * Minimum number of moving parts.
- * Designed for switching on full load with DIN Type fuse links up to a rated current of 400A.
- * Arc quenching chambers to allow for on-load switching.
- * Change of fuse possible by using the Insulated operating rod.
- * Lower flap can be withdrawn by the Insulated operating rod.
- * Flexibility of linking a series of flaps for simultaneous operation.
- * The contacts are rigidly mounted in the housing independent of the terminal bolts.
- * Bolted or Moving blade linked neutral.



Dimensions

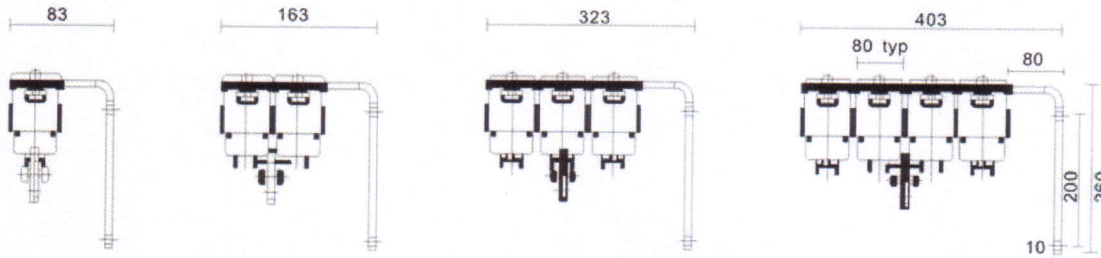

Cutout Fuse



LCF1-60/80A



LCF2-100A

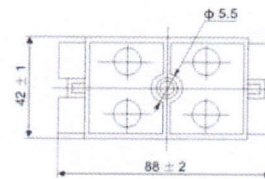

图(Fig.)7.6

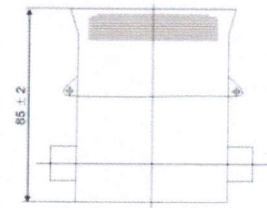

Code No.	Matched fuse with body	Rated voltage	Convection heating current	(mm) Overall dimension	(g) Weight
LCF1	Φ22 x 58	550AC	60/80,100	Fig. 7.6	247
LCF2	Φ30 x 57	550AC	60/80,100		252